

CALL 1-800-999-3600

INCLUDED IN VAT 30 STEEL TUBE OVERHEAD CONFIGURATION FOR KIOSK STANDARD

- (A) STEEL TUBING 203mm (8") X 1219mm (4'-0").
- (B) 25mm (1") CONDUIT 3048mm (10'-0") PAINTED.
- (C) SUPPORT ANGLE KIT, CLAMP SUPPORT, ALL THREAD 1829mm (6'-0") AND UNISTRUT 3048mm (10'-0").
- (D) TRIM RING.
- (E) COUPLING WITH SEAL.
- (F) FLEX HOSE 89mm (3½") DIA. X 15240mm (50'-0") LONG AND ADJUSTABLE HOSE CLAMPS.
- (G) 90° AIR RADIUS 203mm (8") DIA. FLARED AT BOTH ENDS.
- (H) CLAMP SUPPORT AND THREADED ROD 1829mm (6'-0") LONG.
- (J) UNISTRUT 3048mm (10'-0").
- (K) 90° 813mm (2'-8") RADIUS BEND FLARED AT BOTH ENDS.
- (L) STRAIGHT 203mm (8") X 3048mm (10'-0") STEEL.
- (M) 203mm (8") DIA. EXPOSED COUPLING PAINTED WITH SEAL.
- (N) 90° 813mm (2'-8") RADIUS KIOSK BEND FLARED AT BOTH ENDS.
- (P) 90° AIR RADIUS STEEL KIOSK 203mm (8") DIA. FLARED AT BOTH ENDS.
- (Q) CARRIER REMOVAL TUBE PAINTED 203mm (8") DIA. X 457mm (1'-6") LONG FLARED AT BOTH ENDS.

DIMENSIONS IN MILLIMETRES
(DIMENSIONS IN FEET-INCHES)



PAGE 1 OF 1

*ALL DIMENSIONS AND DESIGN CRITERIA
SUBJECT TO CHANGE WITHOUT NOTICE.*

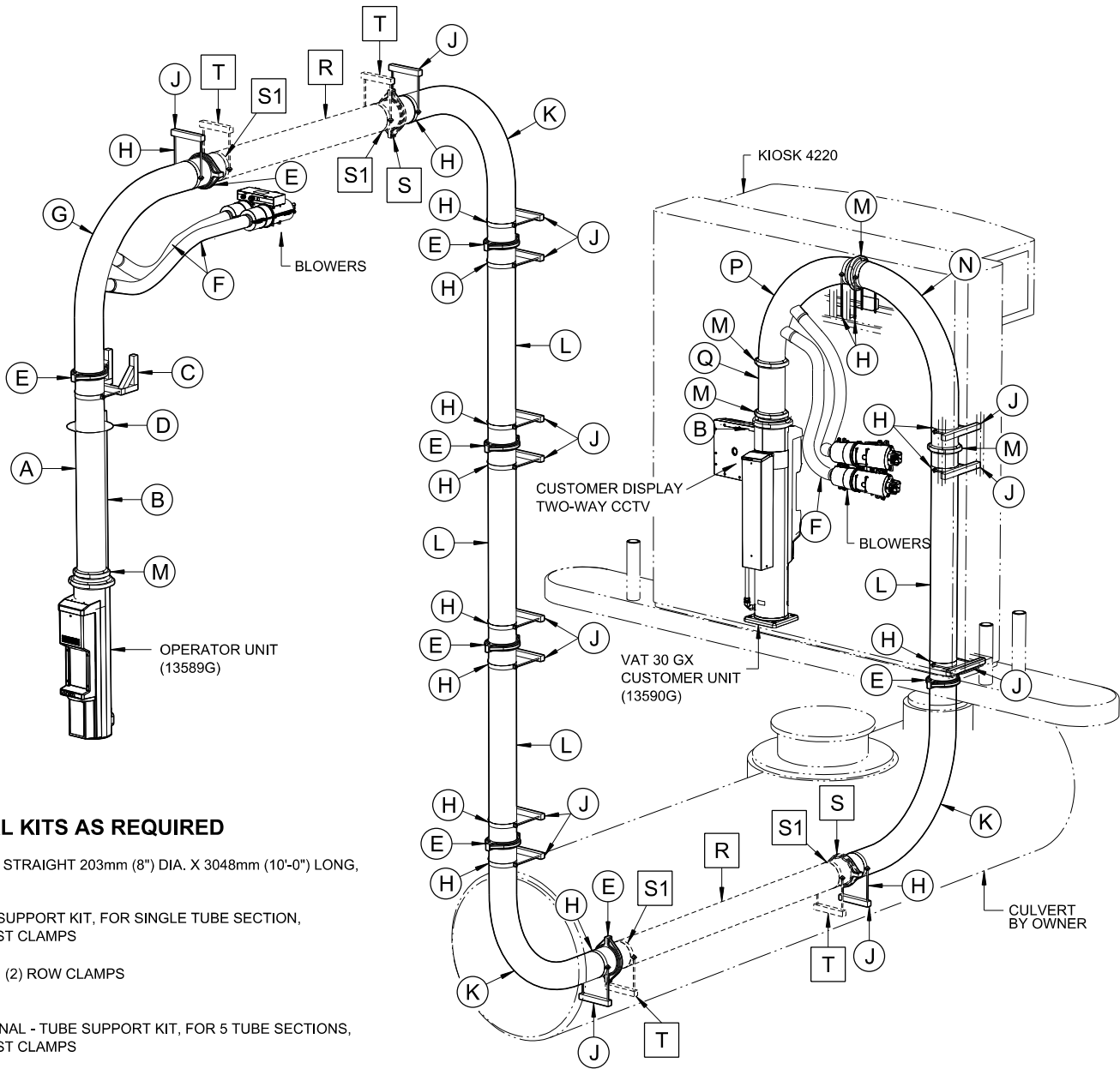

OPTIONAL KITS AS REQUIRED

- (R) STEEL STRAIGHT 203mm (8") DIA. X 3048mm (10'-0") LONG.
- (S) TUBE SUPPORT KIT, FOR SINGLE TUBE SECTION, (1) CAST CLAMPS
- (S1) (2) ROW CLAMPS
- (S) OPTIONAL - TUBE SUPPORT KIT, FOR 5 TUBE SECTIONS, (5) CAST CLAMPS
- (S1) (10) ROW CLAMPS
- (T) THREADED ROD 1829mm (6'-0") LONG AND UNISTRUT 3048mm (10'-0") LONG